

P & PAA Series Attachment

BASE Attachment

Plate model	Applicable to model
F-K15-1	P15
F-K25-1	P30
F-K50-1	P50・PAA50
F-PAA75-1	PAA75
F-P100-1	P100・PAA100
F-P150-1	P150・PAA150

Example

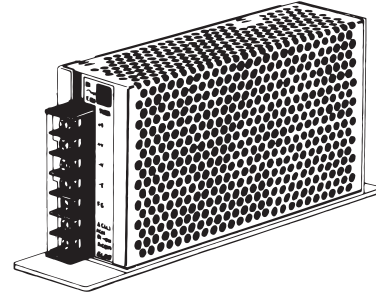

< TOP VIEW > (Unit : mm) (Tolerance : ±1)

F-K15-1	F-K25-1
<p>Size</p> <p>★ Material : SPCC ★ Thickness : 2.0</p>	<p>Size</p> <p>★ Material : SPCC ★ Thickness : 2.0</p>
★ M3 × 6ℓ Flat screw is requested when mounting.	
<p>Mounting hole size</p> <p>FRONT ←</p>	<p>Mounting hole size</p> <p>FRONT ←</p>
F-K50-1	F-PAA75-1
<p>Size</p> <p>★ Material : SPCC ★ Thickness : 2.0</p>	<p>Size</p> <p>★ Material : SPCC ★ Thickness : 2.0</p>
★ M3 × 6ℓ Flat screw is requested when mounting.	
<p>Mounting hole size</p> <p>FRONT ←</p>	<p>Mounting hole size</p> <p>FRONT ←</p>
F-P100-1	F-P150-1
<p>Size</p> <p>★ Material : SPCC ★ Thickness : 2.0</p>	<p>Size</p> <p>★ Material : SPCC ★ Thickness : 2.0</p>
★ M4 × 8ℓ Flat screw is requested when mounting.	
<p>Mounting hole size</p> <p>FRONT ←</p>	<p>Mounting hole size</p> <p>FRONT ←</p>

Example

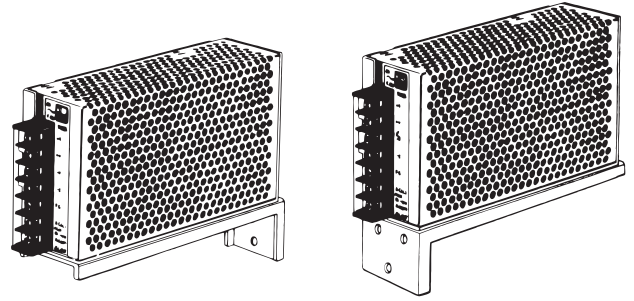

FRONT · REVERSE Attachment

Plate model	Applicable to model
F-K15-2	P15
F-K25-2	P30
F-K50-2	P50 · PAA50
F-PAA75-2	PAA75
F-P100-2	P100 · PAA100
F-P150-2	P150 · PAA150

< TOP VIEW > (Unit : mm) (Tolerance : ±1)

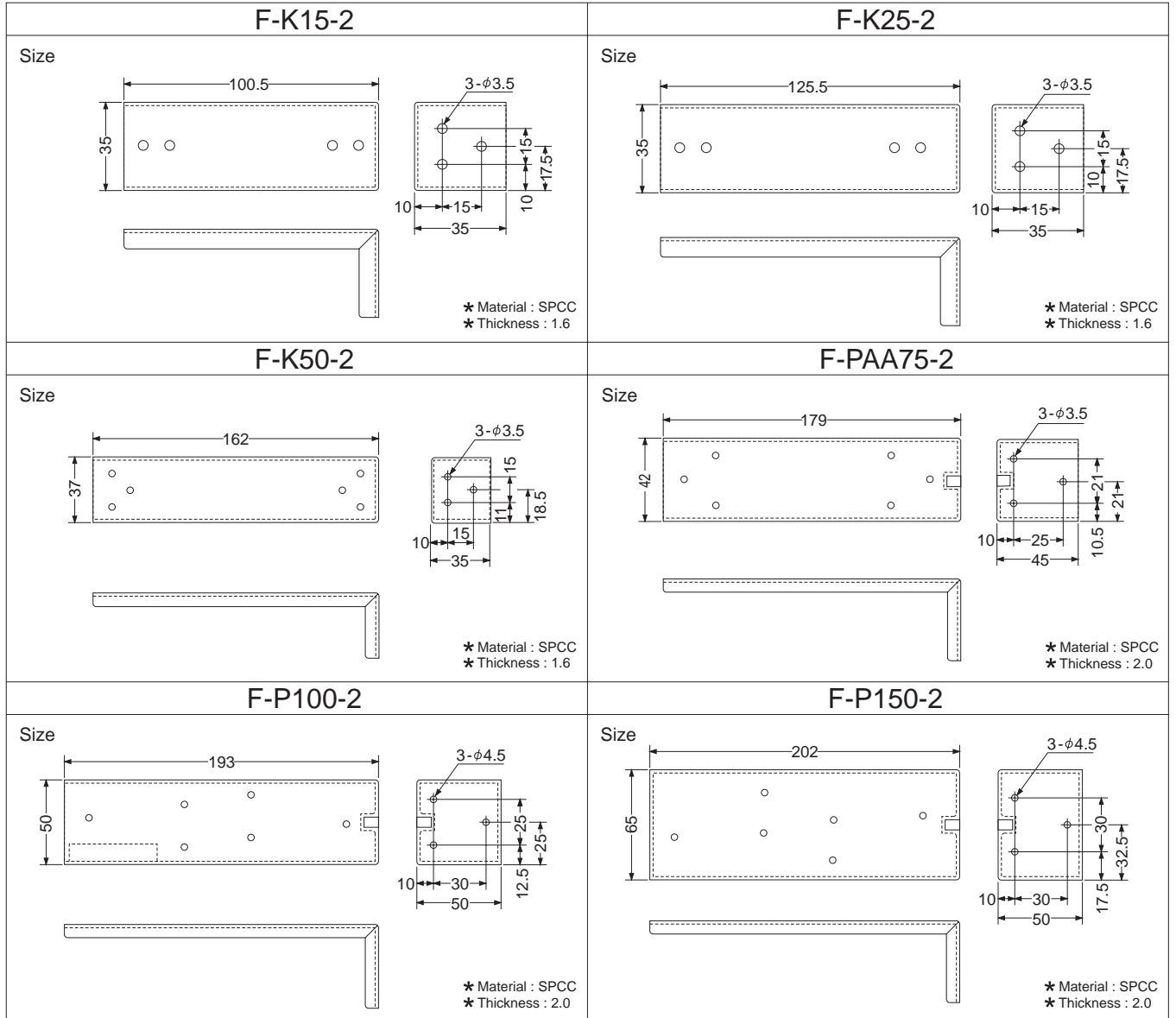

Din rail Attachment Plate

APPLICABLE TO MODEL

Din rail width : 35mm

Plate model	FD-A	FD-B
Model	P30, P50 R50A, PAA50 RMB30A, RMC30A	P15, MMC8A R10A, R15A, R25A RMB15A, RMC15A

EXTERNAL VIEW

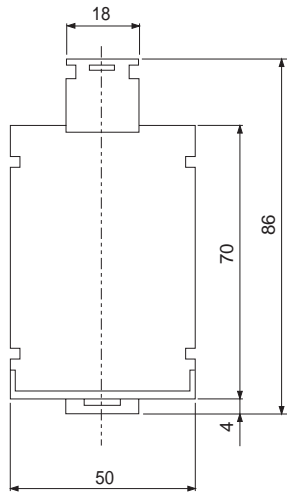
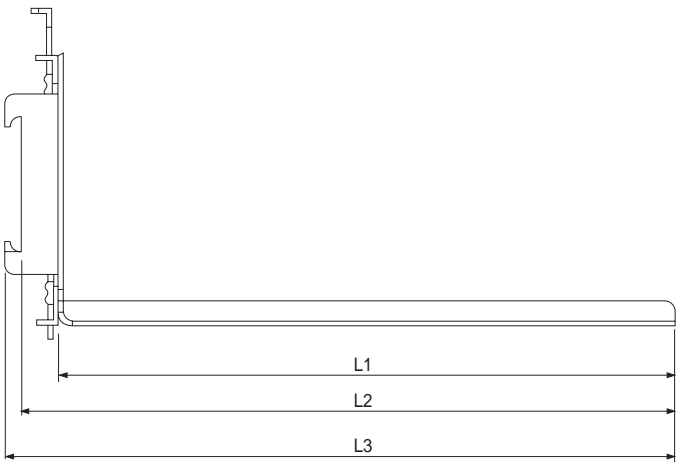

(Unit : mm)

Model	L1	L2	L3
FD-A	165	174.5	178.6
FD-B	115	124.5	128.6

★ Material : SPCC
★ Thickness : 1.6
★ Tolerance : ±1

DIN RAIL ATTACHMENT MODEL : FD-SP

MOUNTING EXAMPLE

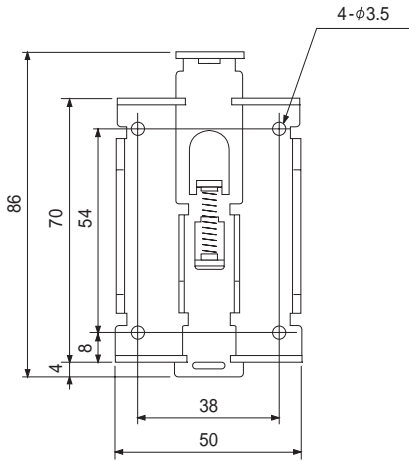
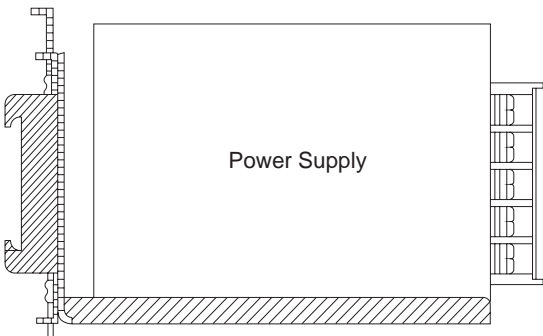

★ Material : SPCC
★ Thickness : 1.6
★ Tolerance : ±1

Terminal Attachment

Terminal attachment to facilitate two or more terminal connections to power supply output is prepared in PAA, UAW, UAF, MAX and ACE series.

Type	Mating Model	Contents
B-PAA600-1	PAA300 PAA600 UAW500 UAF500	Terminal attachment to facilitate two or more terminal connections to power supply output
B-MX-1	PBA600F MAX1600F MAX1600T MAX3200T	Terminal attachment to facilitate terminal connections to power supply output
B-MX-9	MAX1600F MAX1600T MAX3200T	Terminal attachment for series operation as output modules

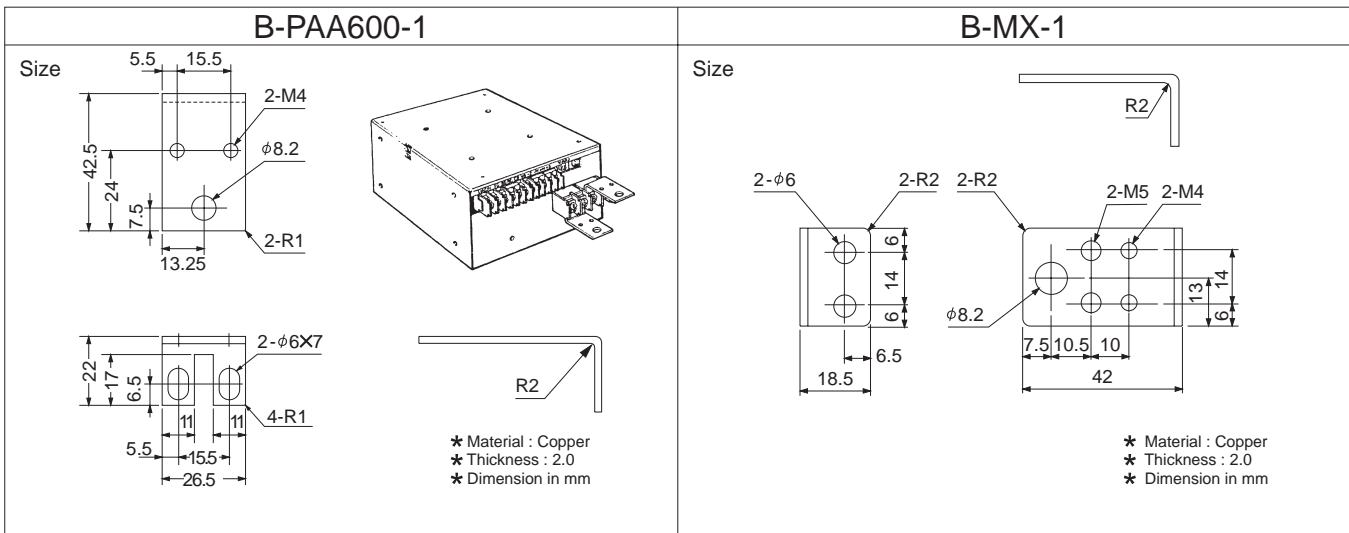

* It is necessary to install the attachments on opposite direction to avoid short-circuit between + and - in terminal block.

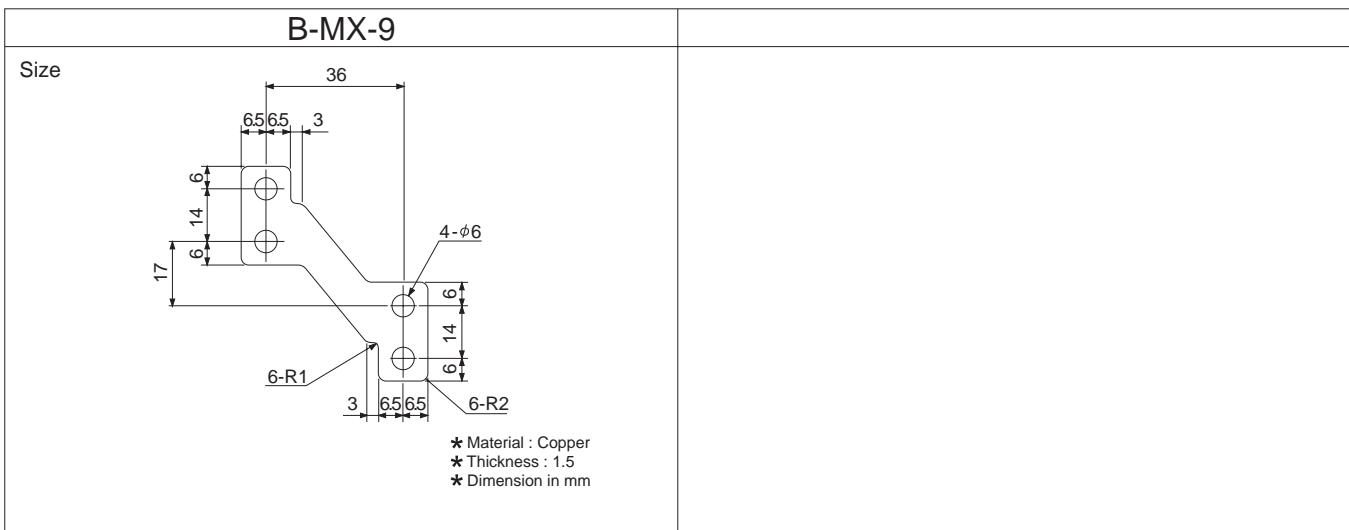

* It is necessary to install B-MX-1 on opposite direction to avoid short-circuit between + and - terminal block.

* Please note the direction of the installation to prevent the short-circuit between the outputs when using B-MX-1 and B-MX-9 at the same time.

* The cover of terminal block does not be attached to B-MX-1 with installation screw and solderless terminal occasionally.

Type	Mating Model	Contents
B-ACE-7	ACE series	Terminal attachment to facilitate faston terminal output modules
B-ACE-8	ACE series	Terminal attachment to facilitate wiring
B-ACE-9	ACE series	Terminal attachment for series operation as output modules

★These attachments cannot be used for module code S, T, U, Y, W, Z, 9, Q, and V.

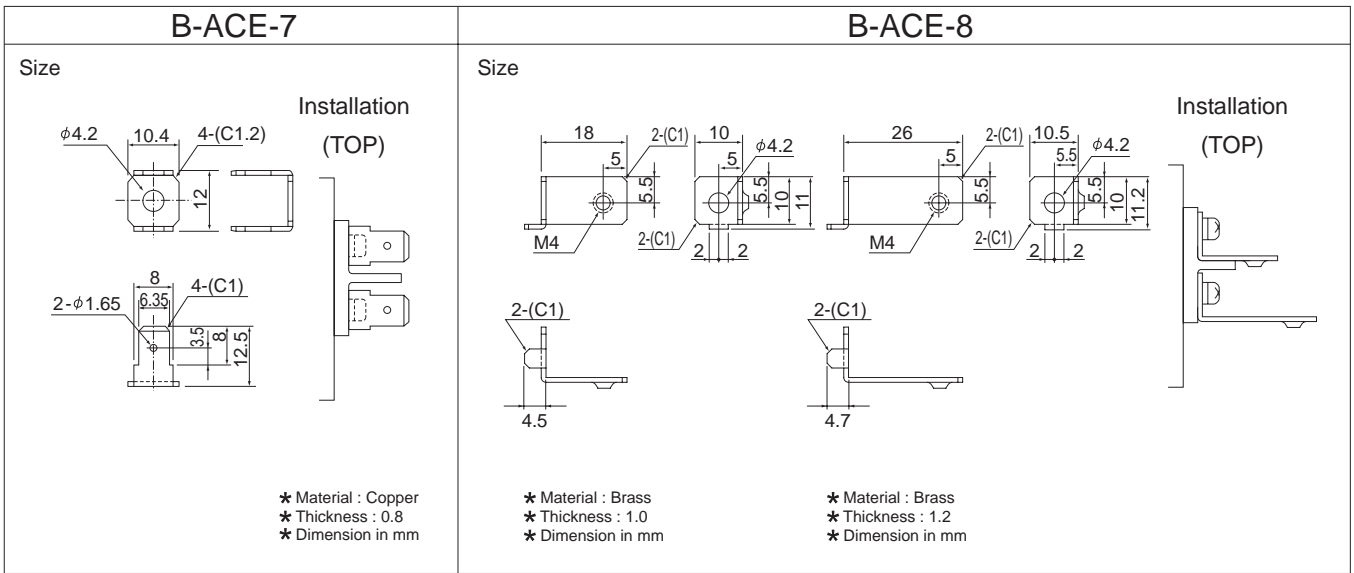

★ B-ACE-7: Recommended faston terminal #250. Quantity is 1 piece.

★ B-ACE-8: Please be careful with that B-ACE-8 is not stressed in wiring. Quantity is a couple.

